

ORDINANCE NO.: 84-9

AMENDMENT TO ORDINANCE NO. 83-19

WHEREAS, on the 28th day of September, 1983, the Board of County Commissioners, Nassau County, Florida, did adopt ORDINANCE NO. 83-19, an Ordinance enacting and establishing a comprehensive zoning code for the unincorporated portion of Nassau County, Florida and

WHEREAS, Issac D. Simmons and Emma Mae Simmons the owner(s) of the real property described in this ordinance, has applied to the Board of County Commissioners for a rezoning and reclassification of that property from Residential (RS-2) to Commercial Neighborhood (CN); and

WHEREAS, the Nassau County Zoning Board, after due notice and public hearing has made its recommendations to the Commission; and

WHEREAS, taking into consideration the above recommendations, the Commission finds that such rezoning is consistent with the overall comprehensive zoning ordinance and orderly development of the County of Nassau, Florida:

NOW THEREFORE, BE IT ORDAINED, by the Board of County Commissioners of Nassau County, Florida:

SECTION 1: Property Rezoned: The real property described in Section 2 is rezoned and reclassified from Residential (RS-2) to Commercial Neighborhood (CN) as defined and classified under the Zoning Ordinance, Nassau County, Florida.

SECTION 2: Owner and Description: The land rezoned by this ordinance is owned by Issac D. Simmons and Emma Mae Simmons and is described as follows:

See Appendix "A" attached hereto and made a part hereof by specific reference.

SECTION 3: Effective Date: This ordinance shall become effective upon being signed by the Chairman of the Board of County Commissioners of Nassau County, Florida.

ADOPTED this 26th day of June, 1984

AMENDMENT NO. R-84-9
TO
ORDINANCE NO. 83-19

CERTIFICATE OF AUTHENTICATION
ENACTED BY THE BOARD

BOARD OF COUNTY COMMISSIONERS
OF NASSAU COUNTY, FLORIDA

ATTEST:



T. J. Greeson
Its: Ex-Officio Clerk

By:

John F. Claxton
Its: Chairman

East Side of Lee Street, 118 feet North of Lewis Street.

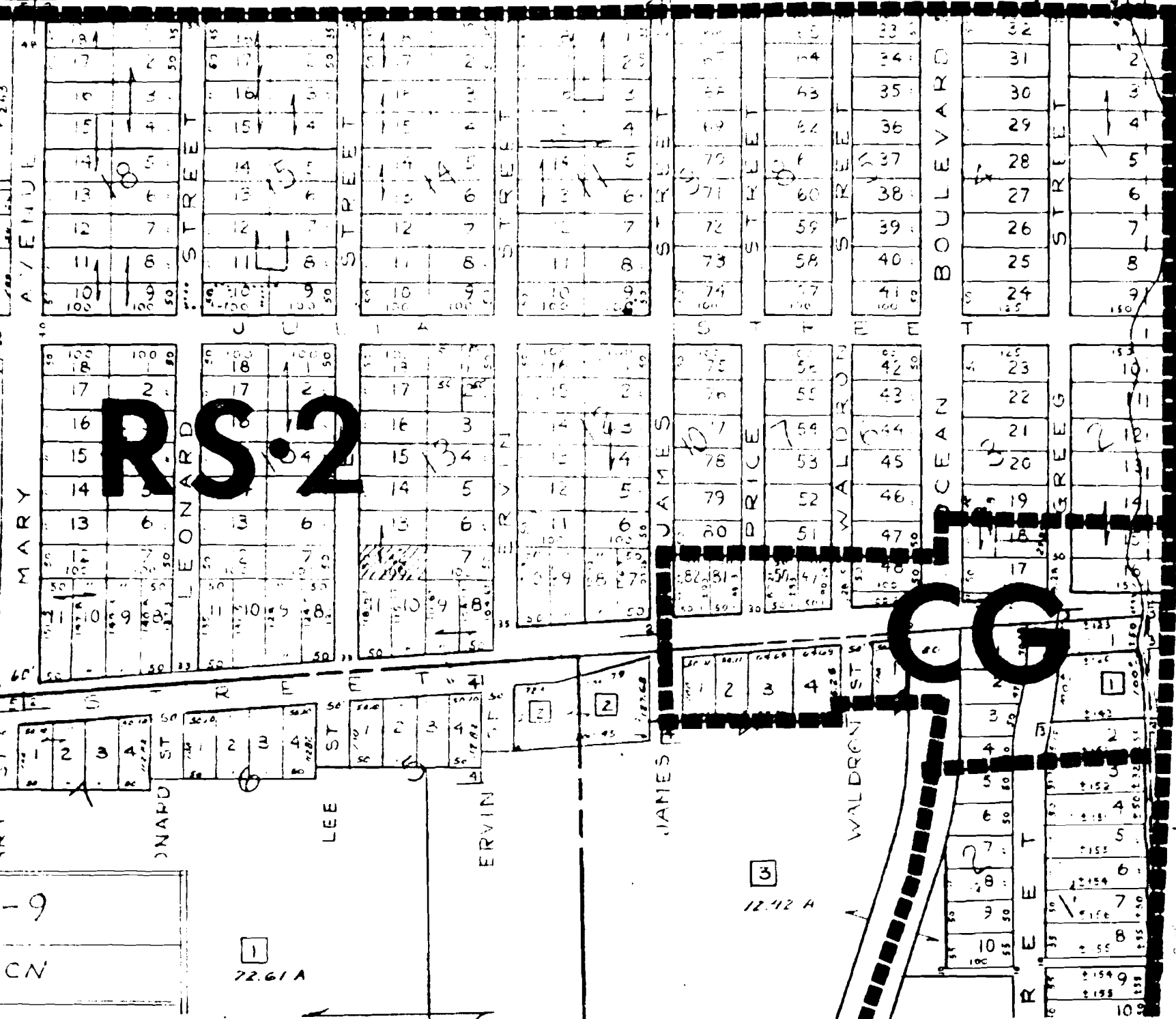
ISLAND



RS-2

CG

R-84-9

RS-2 → CN

1
22.61A

3
12.42A

ATLANTIC